

SIGNATURE

NORTH EAST

OFFICIALLY RATED THE NO.1 ESTATE AGENT IN THE NORTH EAST





 Pedlars Close, Newcastle Upon Tyne NE27 0NY

Pedlars Close, Newcastle Upon Tyne NE27 0NY

Offers Over £350,000

Signature North East is delighted to welcome to the market this four-bedroom detached family home, ideally situated within the highly sought-after Holystone Park development on Pedlars Close. Offering spacious accommodation across three floors, this property benefits from no onward chain and enjoys a fantastic location close to well-regarded schools, local shops and everyday amenities. The stunning Rising Sun Country Park is within easy reach, while nearby Metro stations and excellent road links, including the A19 and Tyne Tunnel, provide convenient access to Newcastle city centre, the wider region and the North Tyneside coastline.

Upon entering the property, you are welcomed into a central hallway with access to a convenient ground floor W.C. The generous living room offers ample space for a range of furnishings, creating the perfect setting for relaxation and entertaining. To the rear, the impressive open-plan kitchen and dining room provides an ideal family hub, with space for a dining table and an abundance of attractive wall and base units complemented by extensive worktop space. Integrated appliances include an oven, hob and fridge freezer, while elegant French doors lead directly to the rear garden.

To the first floor, there are three well-proportioned bedrooms, all capable of accommodating a double bed alongside additional furnishings. Bedroom two benefits from a private en-suite comprising a shower, hand basin and W.C. Completing this floor is the family bathroom, fitted with a bathtub, hand basin and W.C.

Occupying the entire second floor is the spacious principal bedroom, offering ample room for furnishings and a king-size bed, together with a stylish en-suite featuring a shower, hand basin and W.C.

Externally, the property boasts a substantial rear garden laid mainly to lawn, providing an excellent space for outdoor seating, family enjoyment and entertaining. To the side, a driveway offers off-street parking for multiple vehicles and leads to a detached garage.



PLEASE NOTE THAT THE VENDOR HAS CERTIFIED THE PROPERTY INFORMATION AND IMAGES.

PROPERTY FLOORPLAN

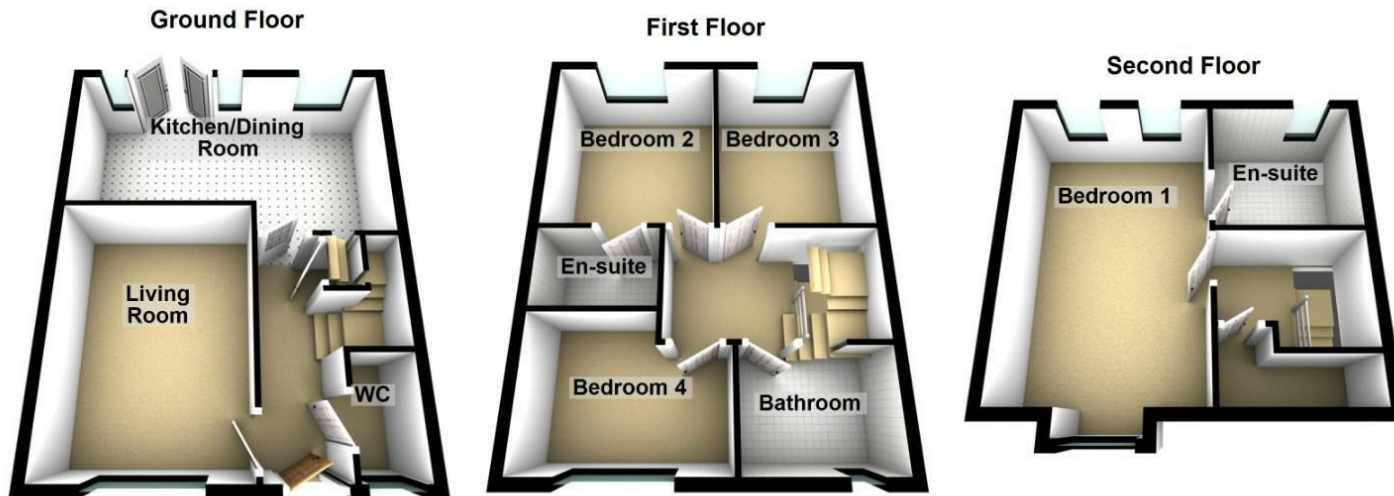

Total area: approx. 119.6 sq. metres (1286.9 sq. feet)

Measurements:

Living Room
14'10" x 10'11"

Kitchen / Dining Room
11'2" x 19'4"

WC
6'2" x 3'4"

Bedroom One
17'1" x 11'4"

En Suite
7'7" x 8'0"

Bedroom Two
11'2" x 10'4"

En Suite
4'6" x 6'8"

Bedroom Three
11'3" x 8'11"

Bedroom Four
11'1" x 8'0"

Bathroom
5'6" x 8'0"

Energy Efficiency Rating

| | Current | Potential |
|---|-----------|---|
| Very energy efficient - lower running costs | | |
| (92 plus) A | | 94 |
| (81-91) B | 85 | |
| (69-80) C | | |
| (55-68) D | | |
| (39-54) E | | |
| (21-38) F | | |
| (1-20) G | | |
| Not energy efficient - higher running costs | | |
| England & Wales | | EU Directive 2002/91/EC  |





More 5 Star Customer Reviews than any other Agent based in the North East on allAgents.co.uk



SALES

LETTINGS

FINANCE

LAW

WE COVER THE WHOLE OF THE NORTH EAST

Whitley Bay
0191 251 3344

Cramlington
01670 897 213

Tynemouth
0191 296 6689

Morpeth
01670 513 966

Ponteland
01661 820 082

Wallsend
0191 432 4151

Alnwick
01665 511 800

Heaton
0191 432 4275

Forest Hall
0191 266 9966

Other locations
0191 640 3523

Newcastle
0191 640 2284

Durham
0191 303 8252

Gosforth
0191 640 3523

Sunderland
0191 543 6390

Whickham
0191 432 5102

Gateshead
0191 432 4294

Jesmond
0191 281 1037

Killingworth
0191 640 3602

Ryton
0191 413 9845

Head Office &
Lettings
0191 253 4815

*Highest recommended 5-star reviews than any other Estate Agent based in the North East on allAgents.co.uk - The UK's Largest Customer Review Website for the Property Industry & Awarded Best Estate Agency 2018 & 2019 - North East England by SME News