

SIGNATURE

NORTH EAST

OFFICIALLY RATED THE NO.1 ESTATE AGENT IN THE NORTH EAST





📍 St. Martins Court, Whitley Bay NE26 3JP

St. Martins Court, Whitley Bay NE26 3JP

Asking Price
£135,000

Signature North East are delighted to welcome this well-presented one-bedroom first floor flat to the market, ideally situated within a popular residential area of Whitley Bay. The property is perfectly positioned close to the beautiful coastline. It is also well placed for a range of local shops, cafés, and everyday amenities, alongside well-regarded schools. Excellent transport links are available via nearby Metro stations, offering convenient access to Newcastle upon Tyne and surrounding areas. The seafront and stunning sandy beaches are just a short distance away, further enhancing the appeal of this well-connected home.

This property benefits from no onward chain.

Upon entering, you are welcomed into a central hallway leading through to a bright living room, offering ample space for a variety of furnishings. The living room provides access to the kitchen via sliding doors, creating a practical and sociable layout. The kitchen itself is sleek and modern, featuring a range of base and wall units complemented by wooden worktops, along with an integrated oven and hob. Adjacent to the kitchen, there is a useful utility room, adding further convenience.

Continuing through the property, you will find a generously sized bedroom which can comfortably accommodate a king-sized bed along with additional furnishings. Completing the internal accommodation is a contemporary shower room, fitted with a shower, hand basin, and WC.

Externally, the property benefits from off-street residents' parking for one vehicle, providing added practicality for everyday living.



PLEASE NOTE THAT THE VENDOR HAS CERTIFIED THE PROPERTY INFORMATION AND IMAGES.

PROPERTY FLOORPLAN

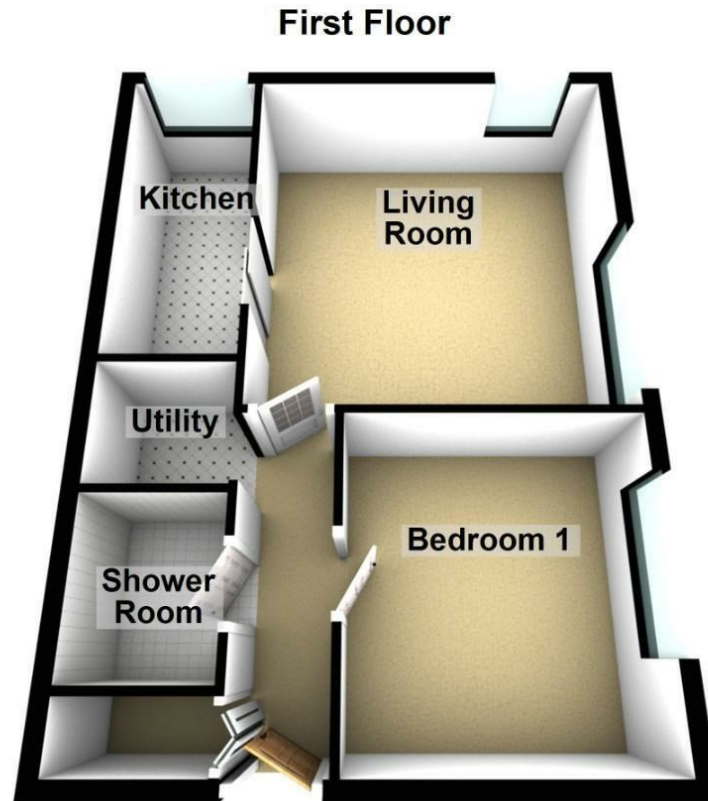

Total area: approx. 50.1 sq. metres (539.8 sq. feet)

Measurements:

Living Room
14'10" x 14'6"

Kitchen
5'1" x 12'7"

Utility
5'1" x 4'7"

Bedroom One
11'11" x 10'8"

Shower Room
5'1" x 6'3"

Energy Efficiency Rating

	Current	Potential
<i>Very energy efficient - lower running costs</i>		
(92 plus) A		
(81-91) B		
(69-80) C		78
(55-68) D	67	
(39-54) E		
(21-38) F		
(1-20) G		
<i>Not energy efficient - higher running costs</i>		

England & Wales

EU Directive
2002/91/EC







More 5 Star Customer Reviews than any other Agent based in the North East on allAgents.co.uk



SALES

LETTINGS

FINANCE

LAW

WE COVER THE WHOLE OF THE NORTH EAST

Whitley Bay
0191 251 3344

Cramlington
01670 897 213

Tynemouth
0191 296 6689

Morpeth
01670 513 966

Ponteland
01661 820 082

Wallsend
0191 432 4151

Alnwick
01665 511 800

Heaton
0191 432 4275

Forest Hall
0191 266 9966

Other locations
0191 640 3523

Newcastle
0191 640 2284

Durham
0191 303 8252

Gosforth
0191 640 3523

Sunderland
0191 543 6390

Whickham
0191 432 5102

Gateshead
0191 432 4294

Jesmond
0191 281 1037

Killingworth
0191 640 3602

Ryton
0191 413 9845

Head Office &
Lettings
0191 253 4815

*Highest recommended 5-star reviews than any other Estate Agent based in the North East on allAgents.co.uk - The UK's Largest Customer Review Website for the Property Industry & Awarded Best Estate Agency 2018 & 2019 - North East England by SME News