

# SIGNATURE

## NORTH EAST

OFFICIALLY RATED THE NO.1 ESTATE AGENT IN THE NORTH EAST





📍 Eden Park Court, Newcastle Upon Tyne NE13 8BA

# Eden Park Court, Newcastle Upon Tyne NE13 8BA

**Asking Price**  
**£390,000**

Signature North East are delighted to welcome this beautifully presented property to the market. This four double bedroom detached home, within a sought after development, placing you in a prime location with close access to Kingston Park amenities and excellent transport links connecting you to the wider North East. Positioned in the well-regarded area of Kenton Bank Foot, the home benefits from being just moments from Kingston Park Retail Park, local supermarkets, and everyday conveniences. Bank Foot Metro Station is within easy reach, providing direct access into Newcastle city centre, while Newcastle International Airport and the A1 motorway are also only a short drive away, making this an ideal base for commuters and families alike.

Upon entering the property, you are greeted by a welcoming hallway that leads through to a spacious and bright living room, ideal for relaxing and entertaining. To the right, a home office. To the left, there is a modern open-plan kitchen and dining area fitted with contemporary units, breakfast bar and integrated appliances, along with a recessed utility area, offering ample space for family life and social gatherings. French doors provide access to the rear garden, allowing for plenty of natural light. The ground floor further benefits from a convenient WC and additional storage.

To the first floor, the property continues to impress with four well-proportioned bedrooms. The main bedroom benefits from built in wardrobes and an en-suite shower room, while the remaining bedrooms are served by a stylish family bathroom complete with modern fixtures and fittings. Each room is thoughtfully designed to maximise space and comfort, making this an ideal home for growing families.

Externally, the property boasts a private rear garden, perfect for outdoor dining and leisure, along with a driveway providing off-street parking and access to a separate garage. The front aspect offers kerb appeal within a well-maintained residential estate, making this an attractive and practical home in a highly desirable location.



PLEASE NOTE THAT THE VENDOR HAS CERTIFIED THE PROPERTY INFORMATION AND IMAGES.

# PROPERTY FLOORPLAN

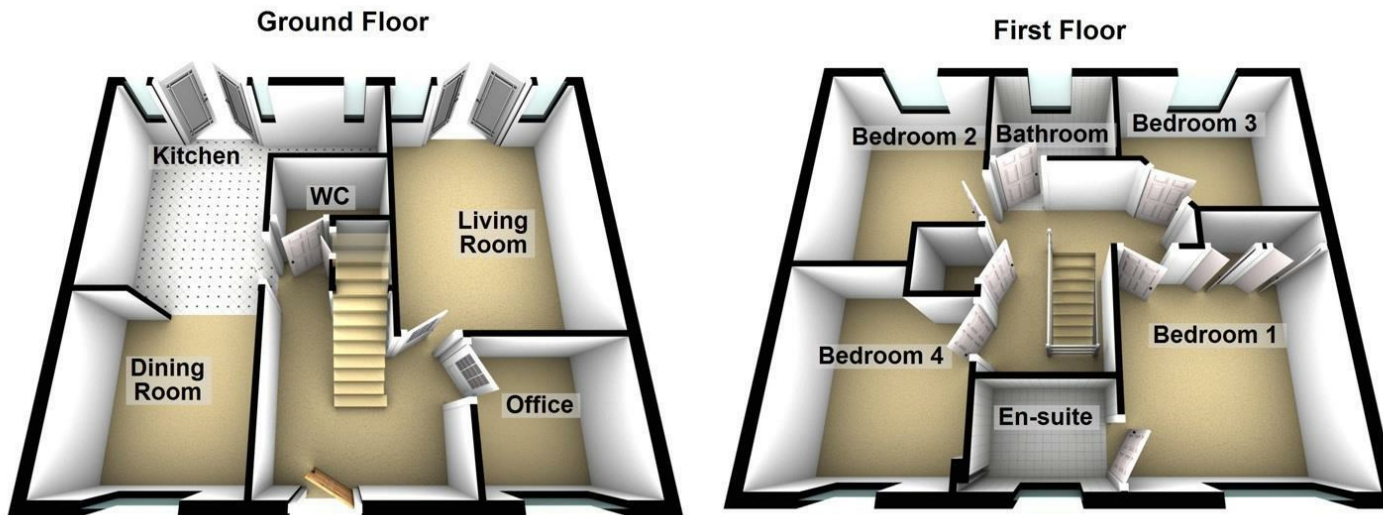

Total area: approx. 113.9 sq. metres (1225.6 sq. feet)

## Measurements:

Kitchen  
12'7" x 6'6"

Dining Room  
9'5" x 9'3"

WC  
3'2" x 5'11"

Living Room  
14'11" x 10'11"

Office  
7'6" x 7'1"

Bedroom One  
11'3" x 11'2"

En Suite  
6'5" x 4'1"

Bedroom Two  
11'10" x 9'6"

Bedroom Three  
8'10" x 10'3"

Bedroom Four  
10'4" x 9'3"

Bathroom  
5'6" x 6'11"

## Energy Efficiency Rating

	Current	Potential
Very energy efficient - lower running costs		
(92 plus) <b>A</b>		<b>94</b>
(81-91) <b>B</b>	<b>84</b>	
(69-80) <b>C</b>		
(55-68) <b>D</b>		
(39-54) <b>E</b>		
(21-38) <b>F</b>		
(1-20) <b>G</b>		
Not energy efficient - higher running costs		
<b>England &amp; Wales</b>	EU Directive 2002/91/EC 	





More 5 Star Customer Reviews than any other Agent based in the North East on allAgents.co.uk



**SALES**

**LETTINGS**

**FINANCE**

**LAW**

**WE COVER THE WHOLE OF THE NORTH EAST**

Whitley Bay  
0191 251 3344

Cramlington  
01670 897 213

Tynemouth  
0191 296 6689

Morpeth  
01670 513 966

Ponteland  
01661 820 082

Wallsend  
0191 432 4151

Alnwick  
01665 511 800

Heaton  
0191 432 4275

Forest Hall  
0191 266 9966

Other locations  
0191 640 3523

Newcastle  
0191 640 2284

Durham  
0191 303 8252

Gosforth  
0191 640 3523

Sunderland  
0191 543 6390

Whickham  
0191 432 5102

Gateshead  
0191 432 4294

Jesmond  
0191 281 1037

Killingworth  
0191 640 3602

Ryton  
0191 413 9845

Head Office &  
Lettings  
0191 253 4815

\*Highest recommended 5-star reviews than any other Estate Agent based in the North East on allAgents.co.uk - The UK's Largest Customer Review Website for the Property Industry & Awarded Best Estate Agency 2018 & 2019 - North East England by SME News