

SIGNATURE

NORTH EAST

OFFICIALLY RATED THE NO.1 ESTATE AGENT IN THE NORTH EAST





📍 Chapel Place, Newcastle Upon Tyne NE13 6EX

Chapel Place, Newcastle Upon Tyne NE13 6EX

£800 Per Month

Signature North East are pleased to present this two bedroom end of terrace house, located on a cul de sac on Chapel Place, Seaton Burn, Newcastle. Excellant location for links to the A1 & A19.

The property comprises a spacious living room leading through to a fitted kitchen with a range of base and wall units. The ground floor also offers the bathroom complete with seperate shower, bath, W.C and hand basin. There are two bedrooms, each offering space for a variety of furnishings.

Externally, the property benefits from a rear yard offering off street parking. Close by to a range of local amenities.

Available Now
Tenancy Term: 12 months
Council Tax Band: A
£800.00 PCM

TENANCY APPLICATION FEES:

To reserve this property, a refundable holding deposit of one week's rent is required, on move in, this will be deducted from your first months rent. A damage deposit for the property is compulsory and is equivalent to 5 week's rent.

NOTICE REGARDING FREE STANDING GAS & ELECTRIC APPLIANCES:

Any free standing appliances shown on photographs or present on viewings may not be included in the tenancy. Please obtain confirmation in writing from our office as to the inclusion of any appliances which you require included within the tenancy, before you proceed with an application for any property.



PLEASE NOTE THAT THE VENDOR HAS CERTIFIED THE PROPERTY INFORMATION AND IMAGES.

PROPERTY FLOORPLAN

Ground Floor



First Floor

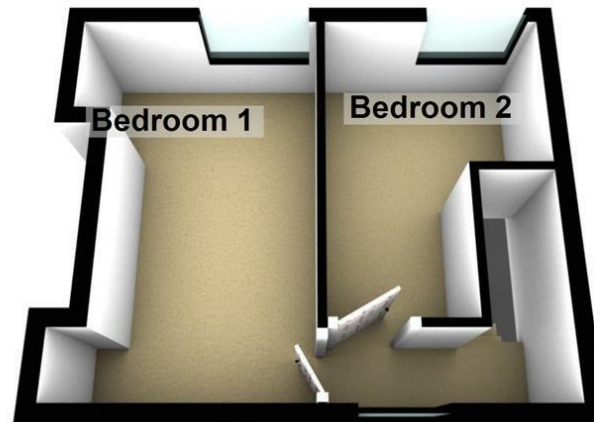

Total area: approx. 60.7 sq. metres (653.1 sq. feet)

Measurements:

Living Room
15'2" x 17'8"

Kitchen
8'3" x 7'11"

Bathroom
9'1" x 7'6"

Bedroom One
15'0" x 9'1"

Bedroom Two
11'8" x 8'2"

Energy Efficiency Rating

	Current	Potential
Very energy efficient - lower running costs		
(92 plus) A		
(81-91) B		84
(69-80) C		
(55-68) D	67	
(39-54) E		
(21-38) F		
(1-20) G		
Not energy efficient - higher running costs		
England & Wales		EU Directive 2002/91/EC 





More 5 Star Customer Reviews than any other Agent based in the North East on allAgents.co.uk



SALES

LETTINGS

FINANCE

LAW

WE COVER THE WHOLE OF THE NORTH EAST

Whitley Bay
0191 251 3344

Cramlington
01670 897 213

Tynemouth
0191 296 6689

Morpeth
01670 513 966

Ponteland
01661 820 082

Wallsend
0191 432 4151

Alnwick
01665 511 800

Heaton
0191 432 4275

Forest Hall
0191 266 9966

Other locations
0191 640 3523

Newcastle
0191 640 2284

Durham
0191 303 8252

Gosforth
0191 640 3523

Sunderland
0191 543 6390

Whickham
0191 432 5102

Gateshead
0191 432 4294

Jesmond
0191 281 1037

Killingworth
0191 640 3602

Ryton
0191 413 9845

Head Office &
Lettings
0191 253 4815

*Highest recommended 5-star reviews than any other Estate Agent based in the North East on allAgents.co.uk - The UK's Largest Customer Review Website for the Property Industry & Awarded Best Estate Agency 2018 & 2019 - North East England by SME News