

# SIGNATURE

## NORTH EAST

OFFICIALLY RATED THE NO.1 ESTATE AGENT IN THE NORTH EAST





📍 Patton Way, Morpeth NE61 6RZ

# Patton Way, Morpeth NE61 6RZ

**Asking Price**  
**£140,000**

Signature North East are delighted to welcome to the market this newly refurbished three bedroom semi-detached property, ideally located in Pegswood, near Morpeth. Set within a peaceful location close to green spaces, the home offers an ideal balance of tranquillity and convenience. Local amenities are just a short walk away, and Pegswood station is nearby, providing excellent transport links for commuting and easy access to surrounding towns and Newcastle City Centre.

Upon entering, you are welcomed into the central hallway, which also provides access to a convenient ground floor W.C. The first step leads you into the large living room, offering ample space for your desired furnishings. A large window allows natural light to flood the room, while a bright feature wall adds a modern feel to the space. The kitchen offers a plethora of storage through wall and base units, complemented by generous countertop space. From here, you can access the rear garden.

Continuing your journey to the first floor, you will discover three bedrooms. Bedrooms one and two can comfortably accommodate a double bed along with additional furnishings, while bedroom three is well suited to a single bed and further furnishings. Completing this floor is the bathroom, featuring a shower, hand basin and W.C.

Externally, this home offers a garden mainly laid to lawn, providing an ideal space to relax or entertain. On-street parking is available at the front of the property, adding further convenience for residents and visitors alike.



# PROPERTY FLOORPLAN

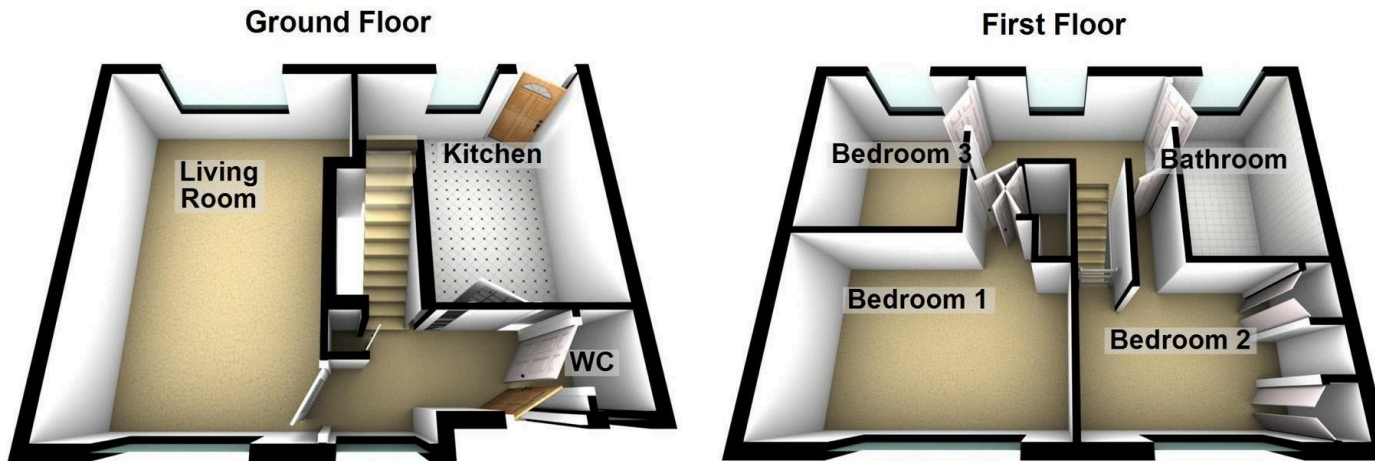

Total area: approx. 73.7 sq. metres (793.7 sq. feet)

## Measurements:

Living Room  
17'8" x 6'6"

Kitchen  
11'3" x 8'3"

WC  
3'6" x 2'7"

Bedroom One  
8'9" x 12'8"

Bedroom Two  
9'9" x 6'2"

Bedroom Three  
8'9" x 7'5"

Bathroom  
9'10" x 5'0"

## Energy Efficiency Rating

	Current	Potential
Very energy efficient - lower running costs		
(92 plus) <b>A</b>		
(81-91) <b>B</b>		<b>83</b>
(69-80) <b>C</b>	<b>69</b>	
(55-68) <b>D</b>		
(39-54) <b>E</b>		
(21-38) <b>F</b>		
(1-20) <b>G</b>		
Not energy efficient - higher running costs		
<b>England &amp; Wales</b>	EU Directive 2002/91/EC 	





More 5 Star Customer Reviews than any other Agent based in the North East on allAgents.co.uk



**SALES**

**LETTINGS**

**FINANCE**

**LAW**

**WE COVER THE WHOLE OF THE NORTH EAST**

Whitley Bay  
0191 251 3344

Cramlington  
01670 897 213

Tynemouth  
0191 296 6689

Morpeth  
01670 513 966

Ponteland  
01661 820 082

Wallsend  
0191 432 4151

Alnwick  
01665 511 800

Heaton  
0191 432 4275

Forest Hall  
0191 266 9966

Other locations  
0191 640 3523

Newcastle  
0191 640 2284

Durham  
0191 303 8252

Gosforth  
0191 640 3523

Sunderland  
0191 543 6390

Whickham  
0191 432 5102

Gateshead  
0191 432 4294

Jesmond  
0191 281 1037

Killingworth  
0191 640 3602

Ryton  
0191 413 9845

Head Office &  
Lettings  
0191 253 4815

\*Highest recommended 5-star reviews than any other Estate Agent based in the North East on allAgents.co.uk - The UK's Largest Customer Review Website for the Property Industry & Awarded Best Estate Agency 2018 & 2019 - North East England by SME News