

SIGNATURE

NORTH EAST

OFFICIALLY RATED THE NO.1 ESTATE AGENT IN THE NORTH EAST





📍 Front Street, Whitley Bay NE25 8DR

Front Street, Whitley Bay NE25 8DR

Asking Price
£140,000

Signature North East welcomes you to this well-presented ground floor apartment, ideally located in the heart of Monkseaton. The property is perfectly positioned to enjoy a fantastic range of convenient amenities, including local shops, popular eateries and bars close by. Monkseaton Metro Station is within easy reach, providing excellent transport links, while the beautiful Whitley Bay Promenade and seafront are just a short distance away.

Step through the entrance hallway into the spacious living room, where a large bay window fills the room with natural light, creating a bright and inviting space to relax. Adjoining the living area is the kitchen, which offers attractive wall and base units with complementary worktops, providing a practical and well-designed space for everyday living.

Continuing through the apartment, you will find two generously sized double bedrooms. The principal bedroom benefits from a convenient en suite, while the family bathroom completes the home and is fitted with a bathtub, overhead shower, wash basin and WC.

Externally, the property enjoys a well-connected location within Monkseaton. Off-street parking is available via a designated parking space, adding further convenience to this desirable coastal apartment.



PROPERTY FLOORPLAN

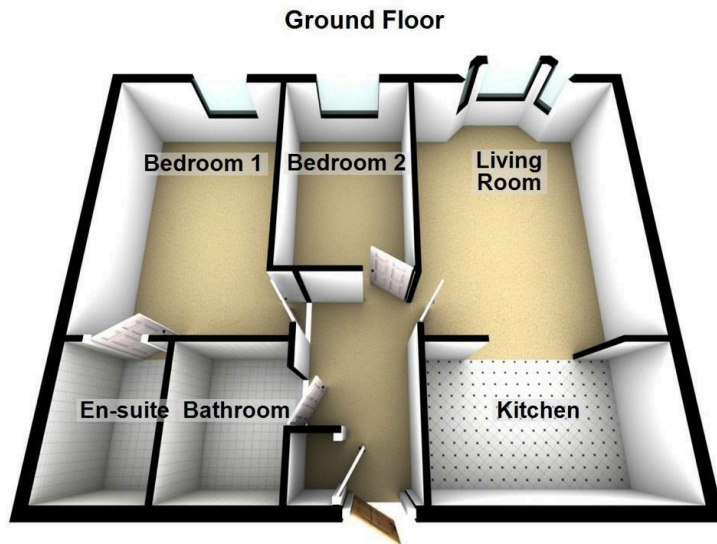

Total area: approx. 61.9 sq. metres (666.2 sq. feet)

Measurements:

Living Room
15'6" x 11'9"

Kitchen
6'11" x 11'9"

Bedroom One
15'3" x 9'5"

En Suite
6'11" x 4'11"

Bedroom Two
11'8" x 7'3"

Bathroom
6'11" x 5'6"

Energy Efficiency Rating

	Current	Potential
<i>Very energy efficient - lower running costs</i>		
(92 plus) A		
(81-91) B	81	81
(69-80) C		
(55-68) D		
(39-54) E		
(21-38) F		
(1-20) G		
<i>Not energy efficient - higher running costs</i>		
England & Wales	EU Directive 2002/91/EC 	

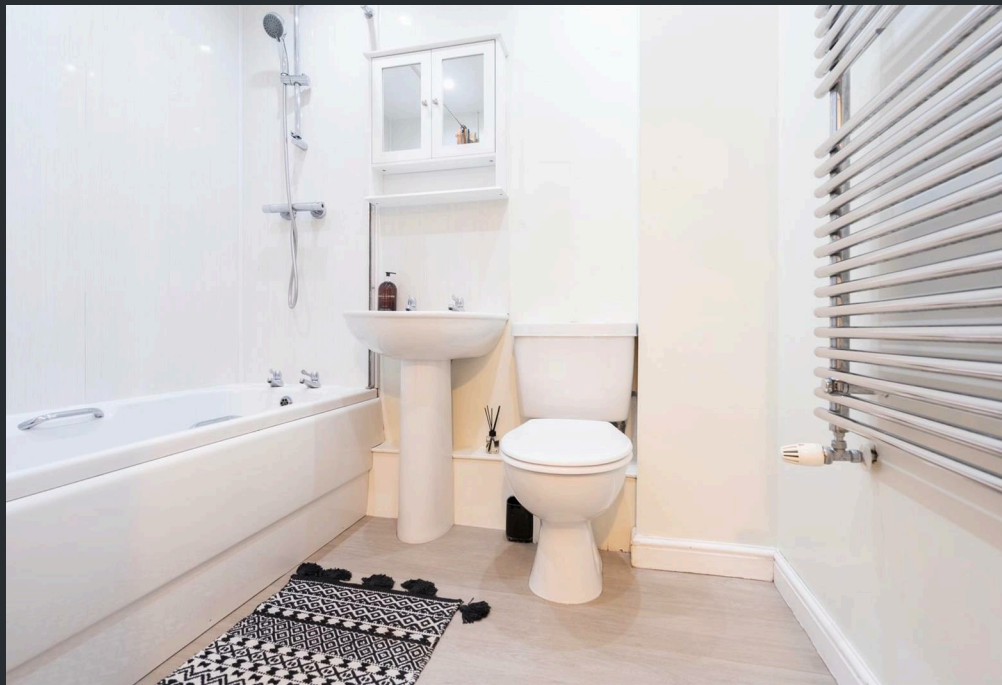



More 5 Star Customer Reviews than any other Agent based in the North East on allAgents.co.uk



SALES

LETTINGS

FINANCE

LAW

WE COVER THE WHOLE OF THE NORTH EAST

Whitley Bay
0191 251 3344

Cramlington
01670 897 213

Tynemouth
0191 296 6689

Morpeth
01670 513 966

Ponteland
01661 820 082

Wallsend
0191 432 4151

Alnwick
01665 511 800

Heaton
0191 432 4275

Forest Hall
0191 266 9966

Other locations
0191 640 3523

Newcastle
0191 640 2284

Durham
0191 303 8252

Gosforth
0191 640 3523

Sunderland
0191 543 6390

Whickham
0191 432 5102

Gateshead
0191 432 4294

Jesmond
0191 281 1037

Killingworth
0191 640 3602

Ryton
0191 413 9845

Head Office &
Lettings
0191 253 4815

*Highest recommended 5-star reviews than any other Estate Agent based in the North East on allAgents.co.uk - The UK's Largest Customer Review Website for the Property Industry & Awarded Best Estate Agency 2018 & 2019 - North East England by SME News