

SIGNATURE

NORTH EAST

OFFICIALLY RATED THE NO.1 ESTATE AGENT IN THE NORTH EAST





📍 Chollerford Mews, Whitley Bay NE25 0TX

Chollerford Mews, Whitley Bay NE25 0TX

£212,500

Signature North East are delighted to welcome to the market this charming two-bedroom end-terraced home, ideally located in the heart of Holywell, just outside Seaton Delaval. Holywell Village enjoys a superb position only a few miles from Whitley Bay and Seaton Sluice, with excellent transport links for easy commutes to both the coast and Newcastle City Centre. The village itself offers a range of local shops, cafés, and pubs, while the picturesque Holywell Dene is right on the doorstep, providing beautiful nature walks. Well-regarded schools are close by, and a nearby train station further enhances convenient travel to Newcastle and beyond, making this an appealing location for families and professionals alike.

The property also offers fantastic potential for further development, including the possibility of an extension, subject to the necessary planning permissions, making it an exciting opportunity for buyers looking to create additional living space in the future.

Upon entering, you are welcomed into a central hallway that leads to the spacious living room. This bright and airy reception area boasts a large window, filling the space with natural light and providing ample room for a variety of desired furnishings. The kitchen offers an abundance of storage and workspace with attractive wall and base units, complemented by sleek countertops. A classic Belfast sink, integrated hob, and oven complete the set-up, and from here you can step directly out to the rear garden.

Upstairs, the property continues to impress with two generously sized bedrooms, each capable of accommodating a double bed along with additional furnishings. Completing this floor is the well-appointed family bathroom, featuring a bathtub with an overhead shower, a hand basin, and a W.C., providing everything needed for comfortable everyday living.

Externally, this home benefits from a large garden laid to lawn, ideal for outdoor furniture and perfect for relaxing or entertaining in the warmer months. The generous outdoor space further enhances the home's future potential for expansion, subject to planning permission. Nearby shared resident car parks provide convenient parking for vehicles, at no added cost, adding to the overall practicality of this delightful property.



PLEASE NOTE THAT THE VENDOR HAS CERTIFIED THE PROPERTY INFORMATION AND IMAGES.

PROPERTY FLOORPLAN

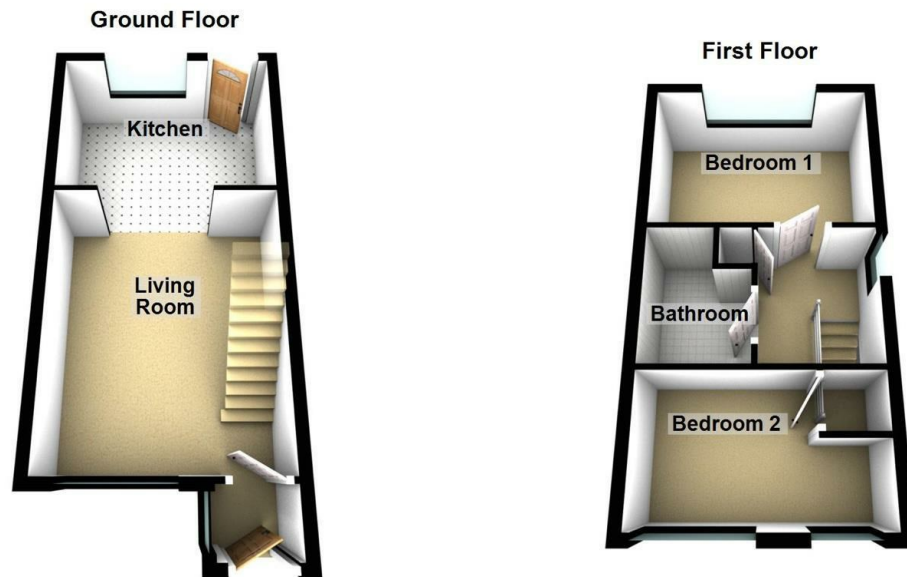

Total area: approx. 58.2 sq. metres (626.1 sq. feet)

Measurements:

Living Room
15'2" x 12'5"

Kitchen
8'11" x 12'5"

Bedroom One
8'11" x 12'5"

Bedroom Two
7'4" x 12'5"

Bathroom
5'8" x 7'6"

Energy Efficiency Rating

	Current	Potential
<i>Very energy efficient - lower running costs</i>		
(92 plus) A		
(81-91) B		87
(69-80) C	71	
(55-68) D		
(39-54) E		
(21-38) F		
(1-20) G		
<i>Not energy efficient - higher running costs</i>		
England & Wales	EU Directive 2002/91/EC 	





More 5 Star Customer Reviews than any other Agent based in the North East on allAgents.co.uk



SALES

LETTINGS

FINANCE

LAW

WE COVER THE WHOLE OF THE NORTH EAST

Whitley Bay
0191 251 3344

Cramlington
01670 897 213

Tynemouth
0191 296 6689

Morpeth
01670 513 966

Ponteland
01661 820 082

Wallsend
0191 432 4151

Alnwick
01665 511 800

Heaton
0191 432 4275

Forest Hall
0191 266 9966

Other locations
0191 640 3523

Newcastle
0191 640 2284

Durham
0191 303 8252

Gosforth
0191 640 3523

Sunderland
0191 543 6390

Whickham
0191 432 5102

Gateshead
0191 432 4294

Jesmond
0191 281 1037

Killingworth
0191 640 3602

Ryton
0191 413 9845

Head Office &
Lettings
0191 253 4815

*Highest recommended 5-star reviews than any other Estate Agent based in the North East on allAgents.co.uk - The UK's Largest Customer Review Website for the Property Industry & Awarded Best Estate Agency 2018 & 2019 - North East England by SME News