

# SIGNATURE

## NORTH EAST

OFFICIALLY RATED THE NO.1 ESTATE AGENT IN THE NORTH EAST





📍 Front Street, Morpeth NE65 8DR

# Front Street, Morpeth NE65 8DR

**Offers Over £225,000**

Signature North East welcomes you to this charming three-bedroom end-terrace home, ideally positioned in the heart of Longframlington. This beautiful property offers the very best of peaceful Northumberland village living, with local pubs, delightful eateries, and stunning green spaces right on your doorstep, making it a perfect retreat for families, couples, or anyone seeking a relaxed lifestyle.

Step into the welcoming hallway, which leads into a stylish living room boasting ample space for furnishings. A large, bright window floods the room with natural light, while characterful features such as exposed ceiling beams and a brick fireplace with a cosy log burner create an inviting atmosphere. The spacious kitchen/diner is equally impressive, fitted with attractive wall and base units, sleek countertops, and space for a dining table, ideal for both everyday living and entertaining. Additional benefits include an integrated fridge and washing machine, with elegant French doors opening out to the rear garden.

Upstairs, the first floor hosts three well-proportioned bedrooms, two of which are generous doubles, providing ample space and flexibility to suit a variety of needs. The bedrooms are light and airy, with plenty of room for furnishings and storage options. The tastefully designed family bathroom features a full-size bathtub with an overhead shower, perfect for both quick morning routines and relaxing evening soaks. A stylish wash basin and WC complete the space, offering both practicality and comfort for everyday living.

Externally, the property enjoys a lovely rear garden, providing a private and peaceful space to unwind or enjoy alfresco dining in the warmer months. Parking is conveniently located close to the property, adding to the appeal of this delightful village home.



PLEASE NOTE THAT THE VENDOR HAS CERTIFIED THE PROPERTY INFORMATION AND IMAGES.

# PROPERTY FLOORPLAN

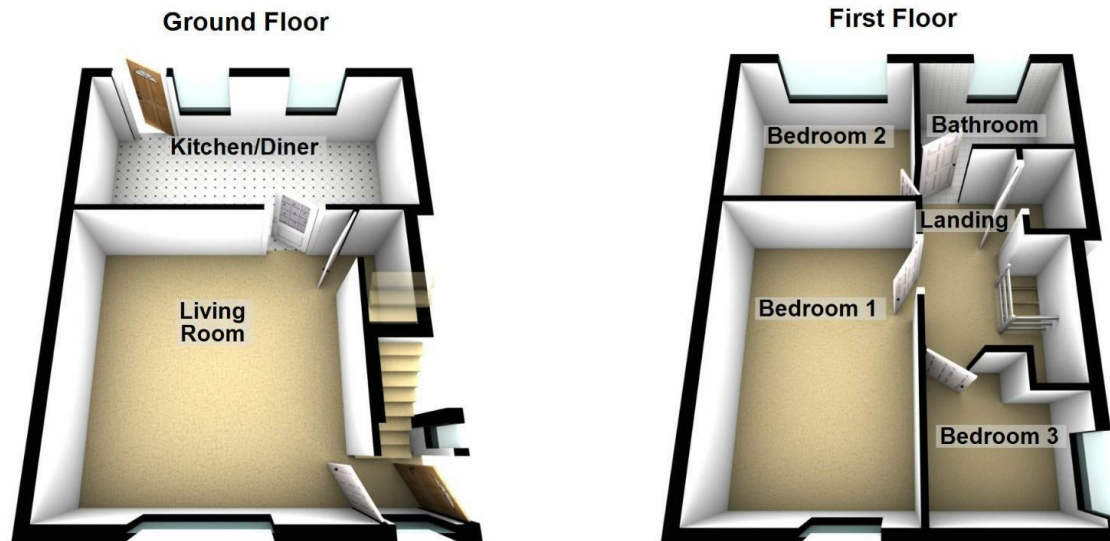

Total area: approx. 75.1 sq. metres (808.6 sq. feet)

## Measurements:

Kitchen/Diner  
8'4" x 18'0"

Living Room  
14'8" x 14'4"

Bedroom One  
14'8" x 9'6"

Bedroom Two  
8'6" x 9'10"

Bedroom Three  
7'1" x 5'4"

Bathroom  
5'3" x 7'10"

## Energy Efficiency Rating

	Current	Potential
Very energy efficient - lower running costs		
(92 plus) <b>A</b>		
(81-91) <b>B</b>		
(69-80) <b>C</b>		
(55-68) <b>D</b>		
(39-54) <b>E</b>		
(21-38) <b>F</b>		
(1-20) <b>G</b>	<b>15</b>	<b>72</b>
Not energy efficient - higher running costs		

England & Wales

EU Directive  
2002/91/EC







More 5 Star Customer Reviews than any other Agent based in the North East on allAgents.co.uk



**SALES**

**LETTINGS**

**FINANCE**

**LAW**

**WE COVER THE WHOLE OF THE NORTH EAST**

Whitley Bay  
0191 251 3344

Cramlington  
01670 897 213

Tynemouth  
0191 296 6689

Morpeth  
01670 513 966

Ponteland  
01661 820 082

Wallsend  
0191 432 4151

Alnwick  
01665 511 800

Heaton  
0191 432 4275

Forest Hall  
0191 266 9966

Other locations  
0191 640 3523

Newcastle  
0191 640 2284

Durham  
0191 303 8252

Gosforth  
0191 640 3523

Sunderland  
0191 543 6390

Whickham  
0191 432 5102

Gateshead  
0191 432 4294

Jesmond  
0191 281 1037

Killingworth  
0191 640 3602

Ryton  
0191 413 9845

Head Office &  
Lettings  
0191 253 4815

\*Highest recommended 5-star reviews than any other Estate Agent based in the North East on allAgents.co.uk - The UK's Largest Customer Review Website for the Property Industry & Awarded Best Estate Agency 2018 & 2019 - North East England by SME News